

NewsLink

Offshore Inland Marine Industrial & Oilfield Services

IN THIS ISSUE

FEATURED PROJECTS

OFFSHORE INDUSTRY TRIVIA

LOCATIONS



Offshore Inland M&O is excited to announce several new deep water Dockside Service Locations:

*

1500' Dockside in Pensacola, FL.

*

800' Concrete private dock on the Theodore Industrial Canal.

*

Available 30 acre laydown / project area with nearby deepwater docks in Galveston, TX.

*

Full Service marine support facility in Tuxspan, MX.

April 2009



To All,

It is my pleasure to share some of our latest news and accomplishment in this current Issue of NEWSLINK. We have had a very busy first quarter and look forward to a sizzling summer of projects and hard work. Note, we have added a new Offshore Industry Trivia section to NEWSLINK.

Thanks to all,

Patrick Webb,

V P - Sales & Marketing

FEATURED PROJECTS

Offshore Inland Marine & Oilfield has completed many successful projects of the past few months. Herein are just a few featured projects.

Helix ESG's Q4000 In and Out!

Offshore Inland M&O recently was the prime contractor on a very successful Dockside Project on the Q4000 in Galveston. This project consisted of a fast pace change out of two thrusters plus other modifications and repairs onboard the U.S. Flag Rig. Mr. Richard Patton, Q4000 Marine Manager stated:



"I want to take the time to let you know that the work done on board the Q4000 was done in a very professional manner and we on the project team want to take the time to thank you for a job well done. We look forward to working with Offshore / Inland again."

CAPABILITIES

We have increased our design and engineering capabilities with the addition of two new engineers including Mr. Brian Wilson, Chief Design Engineer. Some recent design and fabrication accomplishments are as follows:

Crown Sheave design & fabrication for Oceaneering.

Palfinger Deck design, fabrication, & installation for Transocean.

FPSO HPU Power unit design & build for Marecsa, MX.

Vessel Tie in Unit design & manufacture for Subsea 7.

Emergency ROV Tooling design & Build for Technip.

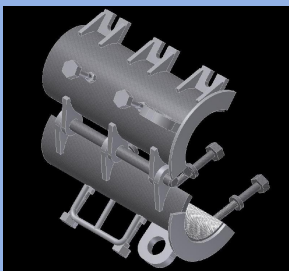

Atwood Oceanic, West Africa Change Out!

Wow! Completed a major two deck crane change out on the Atwood Oceanic Drill Rig, Seahawk. All the structures and equipment was built and/or staged in Mobile, AL and shipped to West Africa. The multi-week project was performed solely by an Offshore Inland M & O Installation Team while the rig was on site drilling. There was no safety down time or operational interruptions. As recently written by Mr. Ronnie Hall, Vice President of Atwood Oceanic:

"...I know of zero examples where such a significant scope of work was conducted in the field while conducting well operations. The crane change out is a significant body of work in a shipyard. The fact that the work was done in the field is indicative of the quality of the people involved and their commitment to safe and efficient simultaneous operations. . . From day one there was simply a group of guys that were focused on getting things done right (safely and efficiently). . . The guys worked up a plan and then executed that plan! To the best of my knowledge no Rig Contractor - Operator partnership has ever even considered such an undertaking much less actually gone out and do it and in West Africa no less."

Finally the project was nominated for the HESS Global Project of the Year! A full article about this successful project can be found in the January Issue of the Maritime Reporter.



Offshore Industry Trivia

Be the first to email the correct answers to both the following OFFSHORE INDUSTRY TRIVIA questions and Win dinner for 2 to your local Ruth Chris Steakhouse. GOOD LUCK!!

1. Who is credited with building the first Wharf and erecting the first Drill Rig on it near Summerland, California in 1887?

2. In what year did Keer-McGee drill the first well from an Offshore Fixed Platform out-of-site of land?

Address your answers to:
ssmith@offshoreinlan.com

(Note: OIMO employees are not qualified to participate in this contest.)

JOIN OUR LIST

Join Our Mailing List!

COMPANY CONTACT INFO

Offshore Inland M&O
2735 Middle Rd.
Mobile, AL 36605
Tel. 251 443 5550
Fax. 251 443 1613
www.offshoreinland.com
info@offshoreinland.com

Commissioning Support of the World's Largest OSV!

Hornbeck Offshore has recently christened the HOS Centerline thanks to the support of Offshore Inland M&O. The breakthrough vessel completed final commissioning at the Offshore Inland's Dockside Service Facility in Mobile, AL. After providing a full spectrum of services from mechanical, welding, electrical, and paint services. Hornbeck's Project Manager, Mr. Randy Trednich recently wrote:

"I certainly appreciate the efforts that Offshore Inland provided. The responsiveness and flexibility of OIS is exactly the type of service we were needing in completing the vessel in the shortest period of time. The craftsmanship and attention to detail was an excellent benefit OIS offered as well. I would like to point out a JOB WELL DONE by OIS!!!"

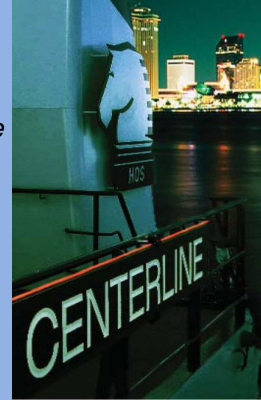

SAFETY



Our commitment:

- To ever increase and enhance our production efficiency and product quality for our customers!
- To provide the safest workplace possible for our employees!
- To promote the cleanest and healthiest environment for us all!

Our safety standards are achieved by our:

- Education of employees on safe work practices
- Proactive hazard identification, elimination and control
- Continual HSE improvement processes
- Promotion of a positive "Safety Culture" lifestyle